

## DESCRIPTION: QUAD PULSE PACKAGE 1 PX

A compact dust collector designed for ease of installation and maintenance, incorporating an integrated fan, BIBO Bin, BIBO Primary and HEPA filters. The QPP 1 is available in models with integrated fan QPP 1 PXI and without QPP 1 PX.

## APPLICATIONS

**Pharmaceutical applications** for the Quad Pulse Package PX1 collector include: **tableting, mixing, blending, granulation, drying, coating, filling and packaging.**

Also applicable for a range of applications within other industries with similar technical demands, including the chemical industry and cosmetics.

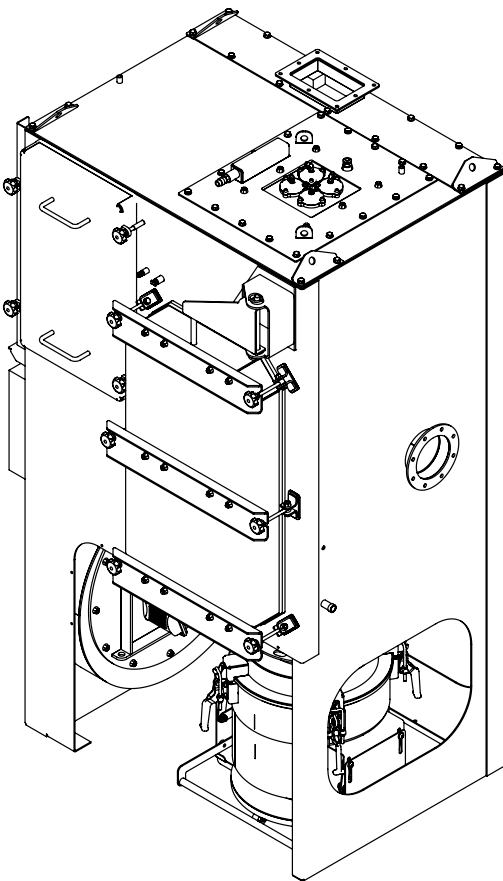

<b>Weight (incl. filters)</b>	1050kg
<b>System dimensions</b>	WxDxH: 1152 x 852 x 2200mm
<b>Noise level</b>	Lp AEQ 90s = 73.2dB
<b>Air Capacity</b>	1000 m <sup>3</sup> /h (range 500-1200 m <sup>3</sup> /h) dependent on application
<b>Process Air Temperature</b>	0 – 40°C non-condensing
<b>Working Pressure</b>	PXI 0 to 5kPa PX 0 to 5kPa
<b>Motor</b>	Only PXI: ATEX ExnA T3 3D T125C, IE3, Class S1, 3x400V, 4kW, 7.3 A, IP55/66 for 3D IIIC
<b>Starter</b>	DOL or VSD available
<b>Integrated Control System</b>	Ex II 3 D, tc, IIIC, IP66, T80C, Dc
<b>Compressed Air Quality</b>	Class 3 or better according to ISO 8573.1

## FEATURES AND BENEFITS

### Quadpulse filter cleaning design (Patent pending)

Provides improved dust release and enhanced filter service life. By cleaning individual segments of the filter element, the air flow variations are reduced to maintain duct air velocities and reduce pressure fluctuations in the dirty air ducting and associated process machinery.

The lower compressed air pressure, improved filter cleaning and high efficiency fan motor all ensure lower energy consumption.

### Containment

Incorporates a safe change BIBO bin and HEPA filter operation. Utilises the surrogate tested Camtain BIBO filter change principle for a safe and simple primary filter change obtaining up to OEB 5.

### Explosion Protection

Ensures an explosion event (ST2 dusts) is safely contained within the Quadpulse dust collector without the need for additional expensive safety devices. Ensures the unit can be safely installed indoors without any limitations and close to the process to greatly reduce the ducting installation requirements.



**EXPLOSION PROTECTION  
(ATEX Compliant)**

<b>Unit marking</b>	Ex 2/3 IP55 (IIIB)/IP66 for IIIC marked units
<b>Max Pred</b>	0.6 bar
<b>Max dust KST</b>	299 bar m/s (IIIA, IIIB) / 200 (IIIC)
<b>Max dust PMax</b>	10 bar m/s ST3 dusts and hybrid mixtures possible with chemical suppression
<b>Rated shock resistance</b>	1 bar

**FRONT VIEW**

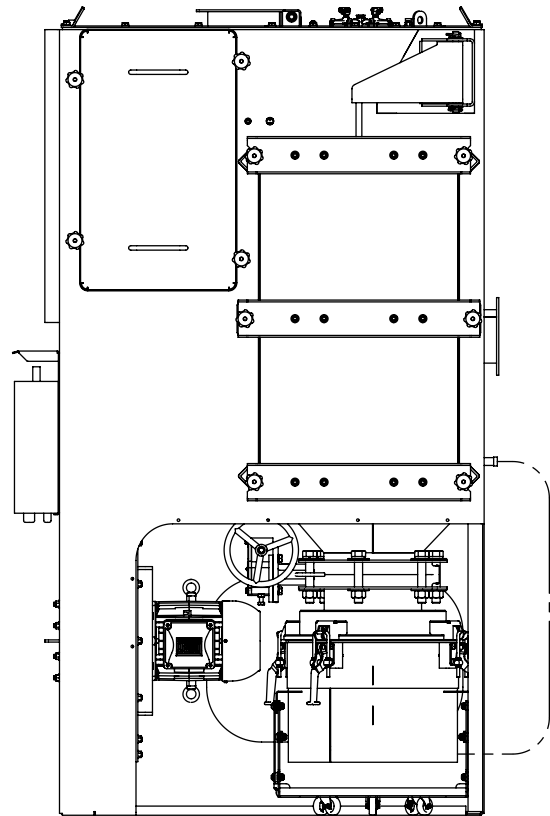

**TOP VIEW**

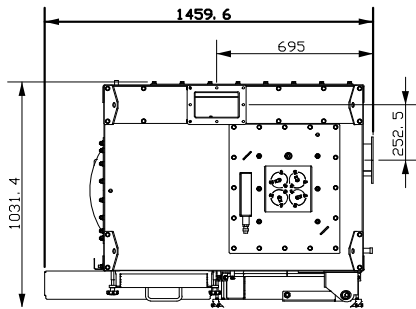

**FOOT PRINT**

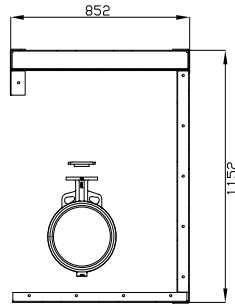

**FILTER**

<b>Main filter</b>	eXtreme Carbon or Durapleat PTFE membrane antistatic
<b>Main filter cartridge class</b>	M EN 60335-2-69
<b>Main filter area</b>	16.7 / 12.7m <sup>2</sup>
<b>Final filter class</b>	H14, 99,995% at MPPS EN 1822
<b>HEPA DOP Testing</b>	Integrated test ports and aerosol injection port for volumetric HEPA testing
<b>HEPA area</b>	22.5m <sup>2</sup>

